



Nautilus

Working with Glass Grain

Design by Mark Waterbury, Text by Marilyn Bryan

Are you a looker or a waiter when it comes to matching glass to pattern? A looker locates a good design, then tries to find glass that suits the pattern. A waiter leans a sheet of glass against a window sill or light box and waits for inspiration before committing it to a pattern.

Regardless of your particular style, you can improve

Youghioghney Opalescent Glass Numbers

- Soft white opal & chocolate brown High Strike, #1313 HS
- White opal, amber & silver yellow, #1025 RG

your glass work by learning to effectively use glass grain. The secret is in pattern piece placement.

Instructions

Start with the largest pattern piece and find an area of glass that serves it well. Position several other pieces around it to get the best use of your sheet of glass. Trace the pattern pieces with a marker. (Continued on page 52)

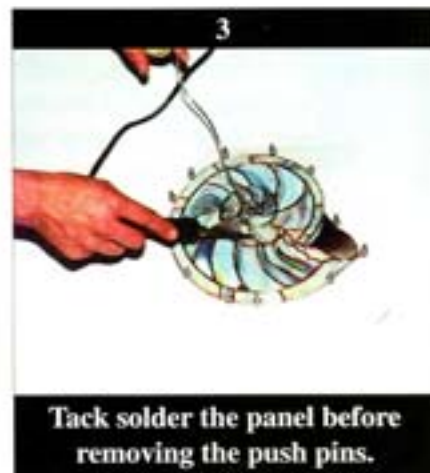

Nautilus

(Continued from page 34)

Surround the panel in 1/4" lead U-channel and hold in place with horseshoe nails.

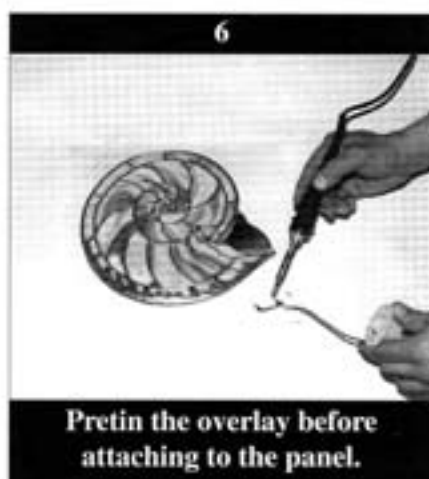
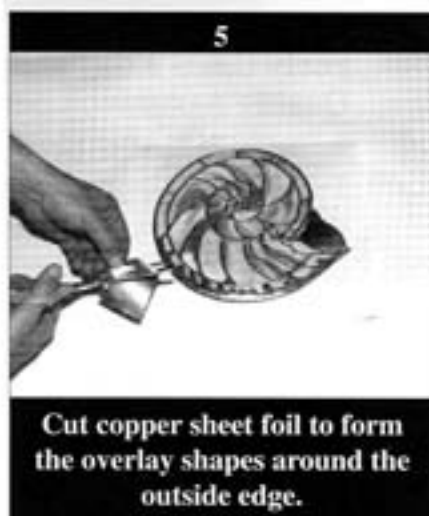
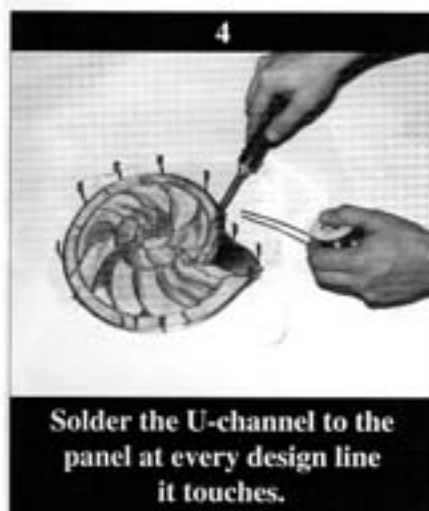



Solder the overlay to the panel.

Note that the overlay covers the solder lines connecting the outer border.

Attach two pretinned wires to the top of the panel for hanging.

Clean and patina the panel. Because the overlay on this project is such an integral part of the overall design, we recommend using black patina. 🍷

Compliments of:

GLASS PATTERNS

• Q U A R T E R L Y •

www.GlassPatterns.com



Design by Mark Waterbury